

Profi 025 Ts – Profi 2 Ts Datasheet

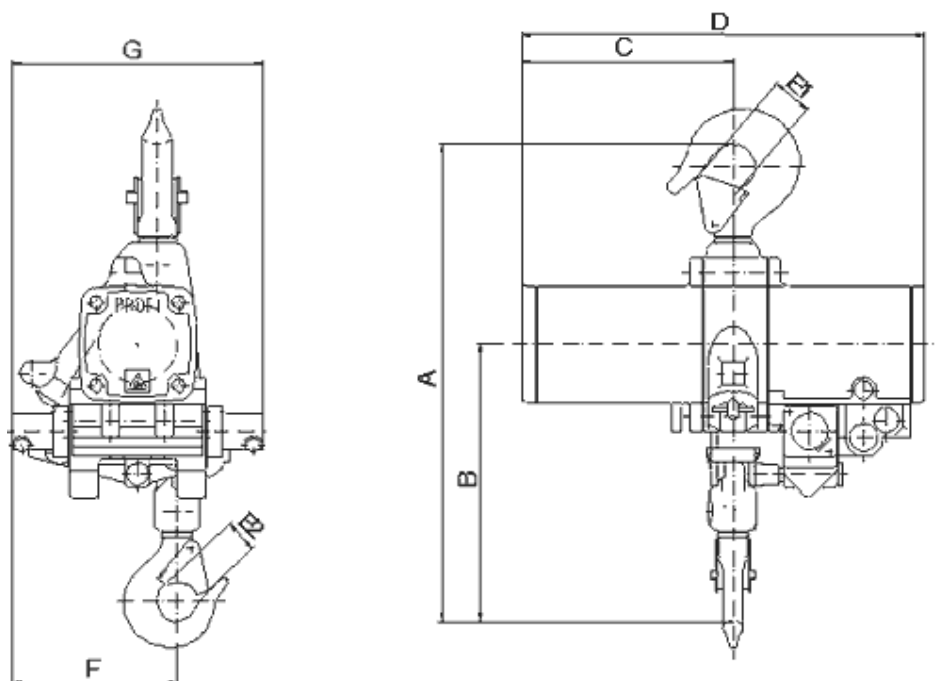

Dimension in mm

Type	025 TS	05 TS	1 TS	2 TS
A smallest headroom *	452	395	410	544
B	298	238	238	370
C	141	144	183	183
D	302	308	348	348
E1	26	26	30	30
E2	26	26	26	30
F up to hook center	132	136	142	116
G biggest width	217	217	217	217

* Chain containers increase the headroom.

See below for Dimensions with chain containers



OneCall is a
division of
CraneCare



Free Phone 0800 652 4646

OneCall Solves it All

www.c1call.co.uk

Email Sales@c1call.co.uk

Fax 0121 333 3996

Dimensions with chain containers

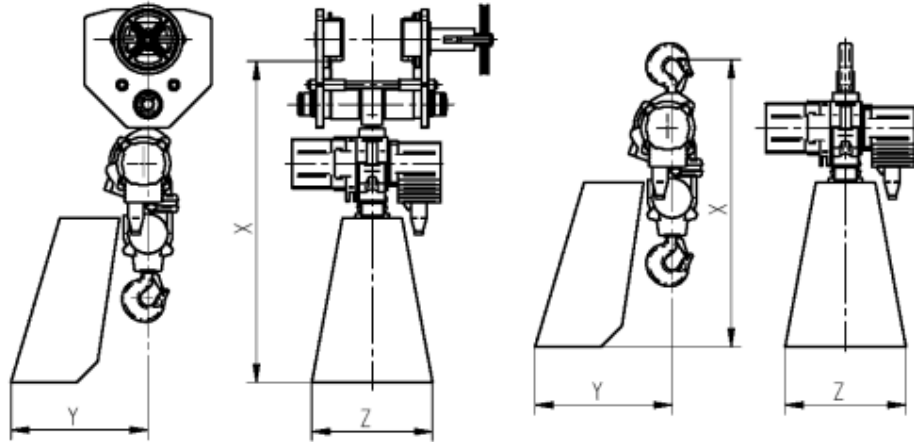

	max. lift	chain container	trolley				
			without	LN	LH / LM	Y	Z
	[m]	type	X			Y	Z
PROFI 025 TS	6	K I	490	570	600	140	165
	10	K II	530	610	640	155	190
PROFI 05 TS	4	K I	495	575	605	140	165
	8	K II	535	615	645	155	190
	15	K III	645	725	755	170	210
PROFI 1 TS	4	K I	510	590	620	170	165
	8	K II	550	630	660	185	190
	15	K III	660	740	770	200	210
PROFI 2 TS	4	K II	550	645	660	160	190
	7	K III	660	755	770	175	210
	11	06	675	770	785	287	352
	16	07	750	845	860	311	391

Type		025 TS		05 TS		1 TS		2 TS	
Air pressure	bar	4	6	4	6	4	6	4	6
Carrying capacity	t	0,16	0,25	0,32	0,5	0,63	1	1,25	2
Number of chain strands		1		1		1		2	
Engine output	kW	0,5	1,0	0,5	1,0	0,5	1,0	0,5	1,0
Lifting speed at full load	m/min	17	20	9	10	4,2	5	2	2,5
Lifting speed without load	m/min	34	44	16	22	9	11	4,3	5,5
Lowering speed at full load	m/min	30	40	16	24	10	12	5	6
Air consumption at full load - Lifting	m ³ /min	1,1	1,4	1,1	1,4	1,1	1,4	1,1	1,4
Air consumption at full load - Lowering	m ³ /min	1,0	1,2	1,0	1,2	1,0	1,2	1,0	1,2
Air connection		G ½		G ½		G ½		G ½	
Hose dimension (ø inside / ø outside)	mm	15	27	15	27	15	27	15	27
Weight at standard lift (3 m), rope control without delta p	kg	21,5		24		27,5		34,5	
Chain dimension	mm	5 x 15		7 x 21		7 x 21		7 x 21	
Weight of 1 m chain	kg	0,54		1,0		1,0		1,0	
Standard lift	m	3		3		3		3	
Length of control at standard lift	m	2		2		2		2	
Sound level at full load ¹ with standard silencer - lifting	dB(A)	73	75	73	75	73	75	73	75
Sound level at full load ¹ with standard silencer - lowering	dB(A)	79	80	79	80	79	80	79	80

¹measured in 1 m distance acc. to DIN 45635 part 20