

Profi 3 Ti – Profi 16 Ti Datasheet

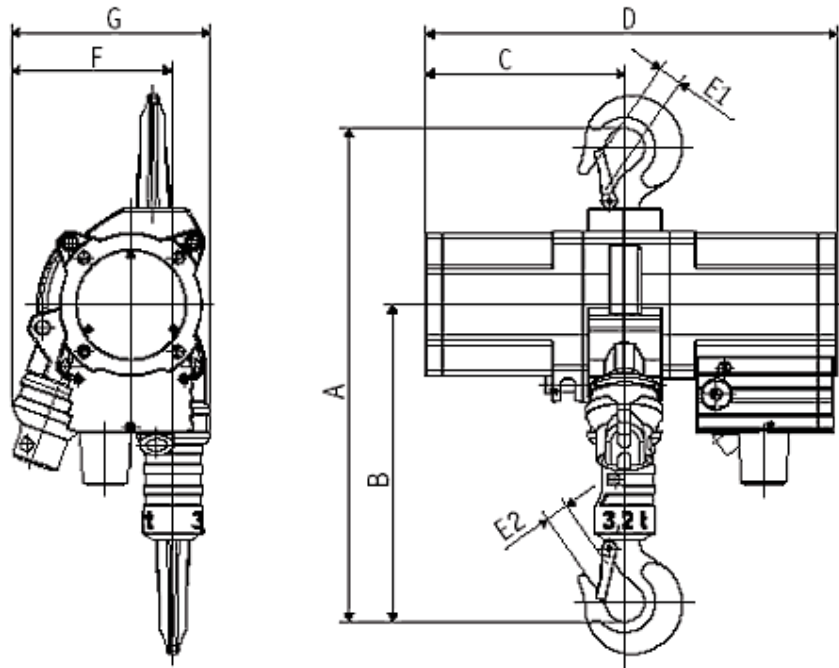

Dimension in mm

Type	3 TI	6 TI	10 TI	16 TI
A smallest headroom *	593	674	813	898
B	373	454	548	598
C	233	233	308	382
D	483	483	575	692
E1	40	40	44	53
E2	30	40	44	53
F up to hook center	187	154	197	199
G biggest width	233	233	306	308

* Chain containers increase the headroom.

See below for Dimensions with chain containers



OneCall is a
division of
CraneCare



Free Phone 0800 652 4646

OneCall Solves it All
www.c1call.co.uk

Email Sales@c1call.co.uk
Fax 0121 333 3996

Dimensions with chain containers

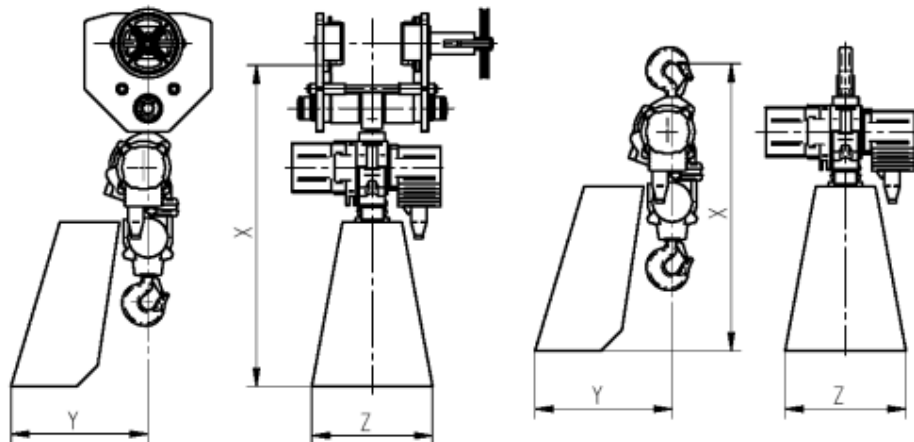

	max. lift [m]	chain container	trolley		Y	Z
		type	without	with		
			X			
PROFI 3 TI	4	10	635	680	416	324
	6	11	685	730	431	342
	10	12	785	830	462	380
	16	13	905	950	496	426
PROFI 6 TI	5	12	830	875	432	380
	8	13	950	995	466	426
	12	14	1060	1105	502	466
	20	15	1250	1295	560	538
PROFI 10 TI	5	13	1000	1130	495	426
	8	14	1110	1240	531	466
	13	15	1300	1430	589	538
	18	16	1450	1580	634	594
PROFI 16 TI	5	14	1145	1240	531	466
	8	15	1335	1430	589	538
	12	16	1485	1580	634	594
	17	17	1675	1770	692	665

Type		3 TI		6 TI		10 TI		16TI	
Air pressure	bar	4	6	4	6	4	6	4	6
Carrying capacity	t	3,2		6,3		10		16	
Number of chain strands		1		2		2		3	
Engine output	kW	1,8	3,5	1,8	3,5	1,8	3,5	1,8	3,5
Lifting speed at full load	m/min	2,5	5	1,2	2,5	0,8	1,6	0,5	1
Lifting speed without load	m/min	6	10	3	5	2	3,2	1,3	2
Lowering speed at full load	m/min	7,5	10,8	3,6	5,4	2,5	3,4	1,6	2,1
Air consumption at full load - Lifting	m ³ /min	2	4	2	4	2	4	2	4
Air consumption at full load - Lowering	m ³ /min	3,5	5,5	3,5	5,5	3,5	5,5	3,5	5,5
Air connection		G ¾		G ¾		G ¾		G ¾	
Hose dimension (ø inside / ø outside)	mm	19/31		19/31		19/31		19/31	
Weight at standard lift (3 m), rope control without delta p	kg	86		110		156		240	
Chain dimension	mm	13 x 36		13 x 36		16 x 45		16 x 45	
Weight of 1 m chain	kg	3,8		3,8		5,8		5,8	
Standard lift	m	3		3		3		3	
Length of control at standard lift	m	2		2		2		2	
Sound level at full load ¹ with standard silencer - lifting	dB(A)	74	78	74	78	74	78	74	78
Sound level at full load ¹ with standard silencer - lowering	dB(A)	79	80	79	80	79	80	79	80

¹measured in 1 m distance acc. to DIN 45635 part 20